

## HX1 Series LED Ex-Proof Lighting

- High lumen LED , reach to 120lm/w, service life over 60,000 hours
- Unique tri-chamber structure
- 3,900 to 22,100 lumen LED high bay lighting
- Various mounting option
- Zone 1, 2, 21, 22 & UL CI D2, CII D2
- UL/ATEX/IECEX certified(pending)
- 5 year warranty



30/50/80/100W  
HX1-A



120/150/200/240W  
HX1-B



Modular Design



## Features:

1. Adopt high lumen Cree/Nichia LED, whole light efficiency reaches 120 lumen/watt;
2. Famous brand Meanwell driver, high reliability, high efficiency;
3. Energy-efficient technology - up to 77% energy savings over HID fixtures;
4. Wide power range, from 30W to 240W;
5. Elegant design with robust structure;
6. Independent chambers for light source, driver and junction box, easy to install;
7. Compact size, light weight, weight is 25% less than traditional heat sink, and volume is 20% less.
8. Wireless connection for junction box, simple to wiring and do maintenance;
9. Versatile mounting options, easy installation.
10. Various kinds of optics designed to maximize light distribution and intensity.
11. Factory sealed, external sealing is not required.
12. Five year warranty.

## Applications:

For areas with mounting heights of 3-20m(10-65ft).

- Oil and gas refineries, drilling rigs, petrochemical facilities, food and beverage facilities, platforms, loading docks, tunnels, indoor/outdoor spotlighting, outdoor wall and stanchion mounted general area lighting, and where flammable vapors, gases, ignitable dusts, fibers or flyings are present.
- Locations requiring continuous and consistent light levels in extreme ambient temperatures.
- Where extremely corrosive, wet, dusty, hot and/or cold conditions exist.
- Classified and hazardous locations.



## Technical Specification:

Classification	Zone 1 - Zone 2 (Gas) & Zone 21 - Zone 22 (Dust) Class I, Div 2, Group A B C D; Class II, Div 2, Group E F G; Class III, Simultaneous Presence							
Standards	EN60079-0:2002, EN60079-1:2010, EN60079-31:2009, EN600598-2-1:1989, UL844; UL1598 Luminaires; UL1598A Marine; cUL Listed to CSA Standard CSA C22.2 No. 137							
Ex-mark	Exd IIC T5 Gb/Ext III BT100°C Db(*1)							
Rated Voltage	AC100-277V, 50/60Hz; AC347-480V 50/60Hz							
Housing Type	A				B			
Rated Wattage(W)	30W	50W	80W	100W	120W	150W	200W	240W
Luminous Flux(LM)	3963	5825	9778	11768	14400	18000	24000	28800
Color Temperature	3000/5000K							
IP Grade	Wet Locations, Type 4X, IP66							
Ambient temperature	-40°C ~ +55° / -40°F ~ +131°F							
Cable Entry	G3/4"/NPT 3/4"/M25HX1.5(adaptor for M20, NPT 1", 1-1/2")							
Terminals	wires ≤ 2.5mm <sup>2</sup> , cable dia 10-14mm							
Installation	Hook/Ceiling/Wall/Pole/Pendant/Bracket/Dust Hood							
Beam Angle	45° /60° /90° /120° /Diffused							
Weight	6.5kg/14 lbs				9.32kg/21 lbs			

## LED System:

### LED system lifetime rated versus economic life:

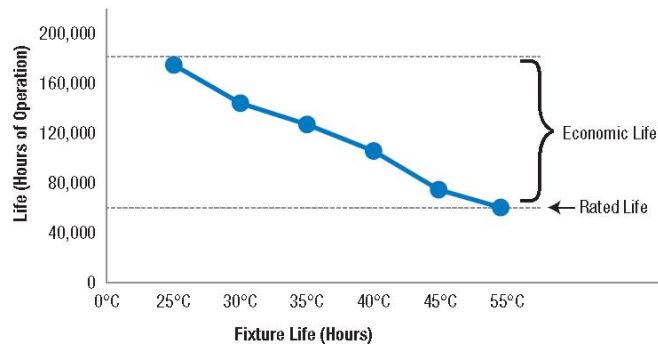

Economic life can range anywhere between 60,000 to 170,000 hours, or 7 to 20 years of maintenance-free operation.

### Fixture life and years of maintenance-free operation

Ambient temperature	Fixture life (hours)	No. of years at 24 hours usage	No. of years at 12 hours usage
25°C	172,060	20	39
30°C	143,383	16	33
40°C	107,537	12	25
55°C	60,000	7	13

## Fixture Life:

- Rated life of 60,000 hours @ 55° C operating ambient and 24/7 continuous operation for 365 days
- Economic life of 170,000 hours @ 25° C ambient
- L70 >400,000 hours @ 55° C

## LED Driver:

Input Voltage	100-277V AC, 347-480V 50/60Hz
Surge Protection	2KV line-line, 4KV line-ground
THD	<20%
Safety Standard	EN61347-1/EN61347-2-13
Power Factor	0.98 (220V/full load)
Protection	Short Circuit/Over Voltage/Over Heat/Surge Protection
IP	IP67

## Standard materials:

- Lamp housing and adapter - die cast aluminum with anti-corrosion powder coat
- Lens - heat & impact resistant tempered glass
- Gaskets - silicone
- External hardware - stainless steel
- Factory-sealed, no external seals required

## Parts Weight:

Part Name	Weight
HX1-A body	6.5 kg/14 lbs
HX1-B body	9.32 kg/21 lbs
Ceiling	1.1 kg/2.4 lbs
Wall straight	2.4 kg/5.3 lbs
Wall 30°	2.6 kg/5.7 lbs
Pendant	0.6 kg/1.3 lbs
Stanchion straight	2.3 kg/5.1 lbs
Stanchion 30°	1.3 kg/2.9 lbs
Bracket	0.7 kg/1.5 lbs
Cone	0.7 kg/1.5 lbs

## System Luminous Flux:

Model	Typical Lumens	Wattage	Lumen/Wattage	Equivalent HID luminaire
HX1-A30-120°	3963	33W	120.1	70-100W
HX1-A50-120°	5824.6	50W	116.5	100-150W
HX1-A80-120°	9778	79W	123.8	175-250W
HX1-A100-120°	11767.7	98W	120.1	320-400W
HX1-B120-45°	12230.4	117W	104.5	400W
HX1-B120-120°	14400	117W	120	400W
HX1-B150-45°	14512.5	145W	100.1	400-600W
HX1-B150-120°	18000	145W	120	400-600W
HX1-B200-45°	19780	194W	102.0	600-750W
HX1-B200-120°	24000	194W	120	600-750W
HX1-B240-45°	21985.8	230W	95.6	750-1000W
HX1-B240-120°	28800	231W	120	750-1000W

\* Tolerance +/- 10%.

## Dimension:

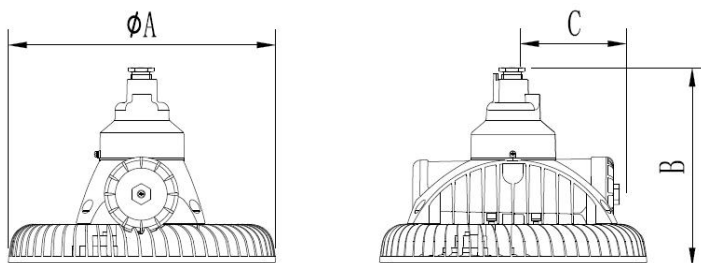

TYPE	A(mm)	B(mm)	C(mm)
HX1-A	360(14.2")	255(10")	115(4.5")
HX1-B	280 (11")	265(10.4")	144(5.7")

# Installation(mm/inch)

Ceiling

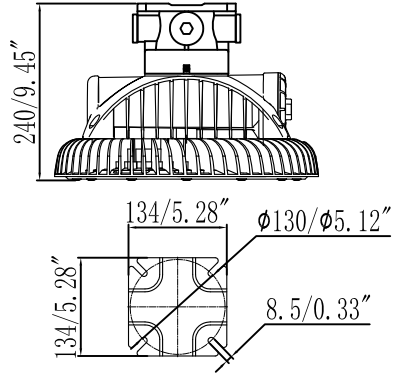

Wall Straight

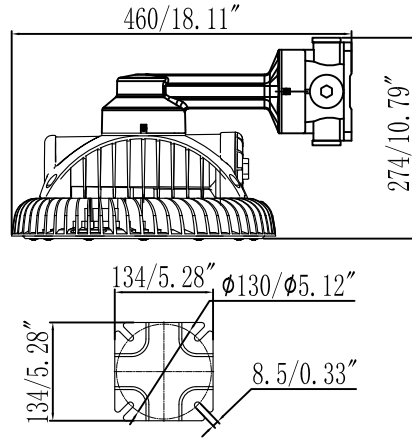

Pendant

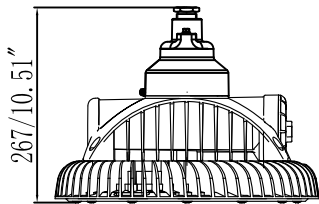

Stanchion 30°

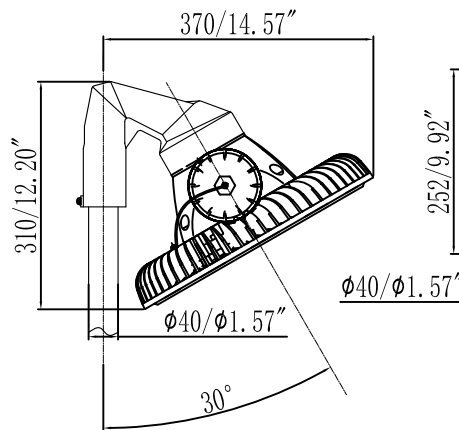

Stanchion Straight

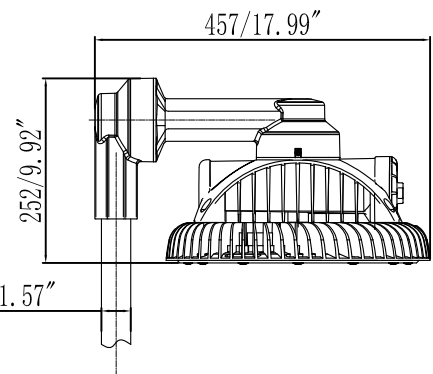

Bracket

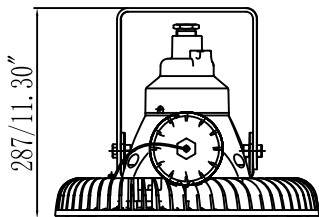

Wall 30°

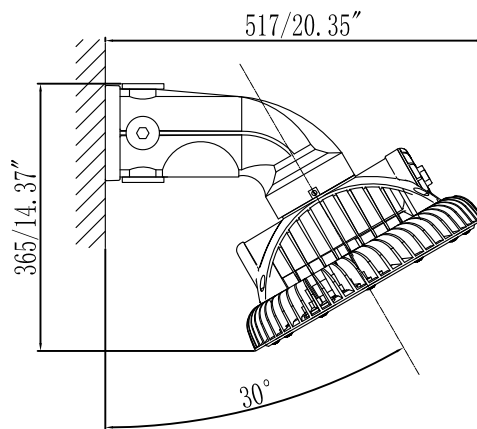

Cone Pendant

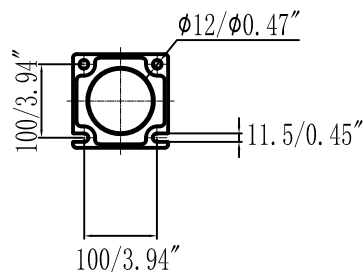
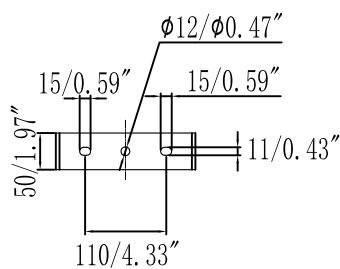
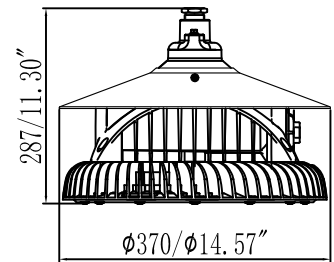

Remark:  
Ceiling and wall mounting has 4 hubs.

# Ordering Information

Part Number Example

**HX1 - A 80 C N W 1 V1 S001**

A - 30-100W  
B - 120-240W

N - NPT  $\frac{3}{4}$ "  
M - M25x1.5  
G - G $\frac{3}{4}$ "

1 - 45°  
2 - 60°  
3 - 90°  
4 - 120°  
5 - Diffused

S001 - Safety Cable  
S002 - Wire Guard

30 - 30W  
50 - 50W  
80 - 80W  
100 - 100W  
120 - 120W  
150 - 150W  
200 - 200W  
240 - 240W

C - Ceiling  
H - Hook  
P - Pendant  
B - Bracket  
W1 - Wall Straight  
W2 - Wall 30°  
S1 - Stanchion Straight  
S2 - Stanchion 30°  
D - Cone Pendant

C - Cool(5000K)  
N - Neutral(4000K)  
W - Warm(3000K)

V1 - 100-277V AC  
V2 - 347-480V AC